

An aerial photograph of a lush green forested landscape. A dark, winding river or stream flows through the center of the image, creating a meandering path. The surrounding land is covered in dense green trees and vegetation, with some lighter green areas suggesting different types of trees or perhaps a wetland area. The overall scene is a natural, undisturbed environment.

Multi-Generational Thinking:
The Wisdom of the Haudenosaunee

Garrison Institute:
Climate, Buildings, and Behavior

Bob Fox

Terrapin Bright Green
Cook+Fox Architects



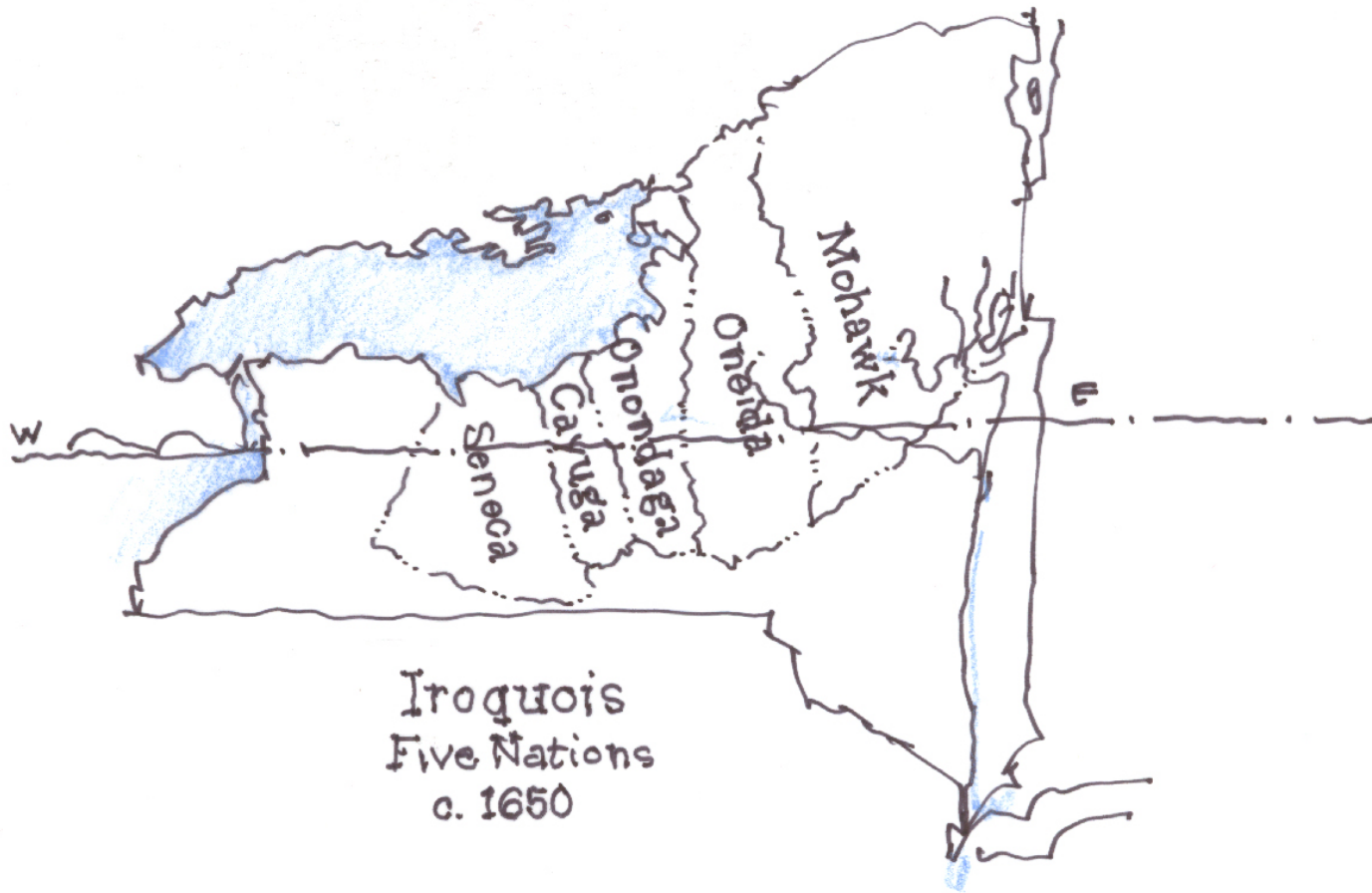

Iroquois
Five Nations
c. 1650

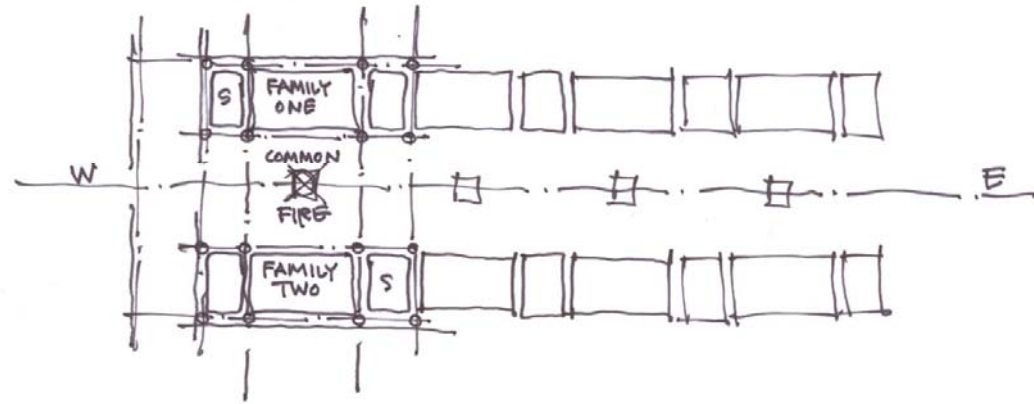
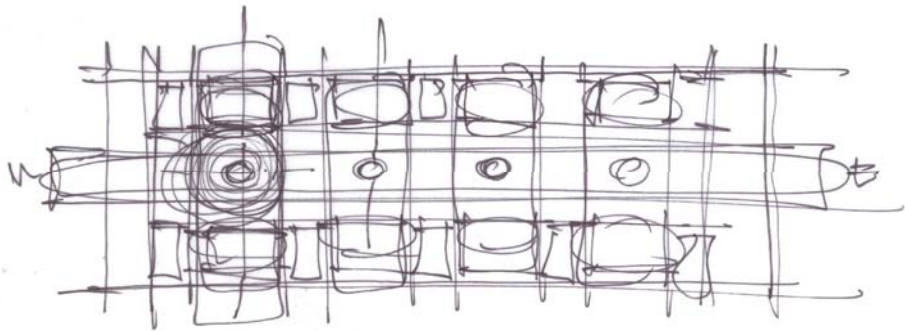

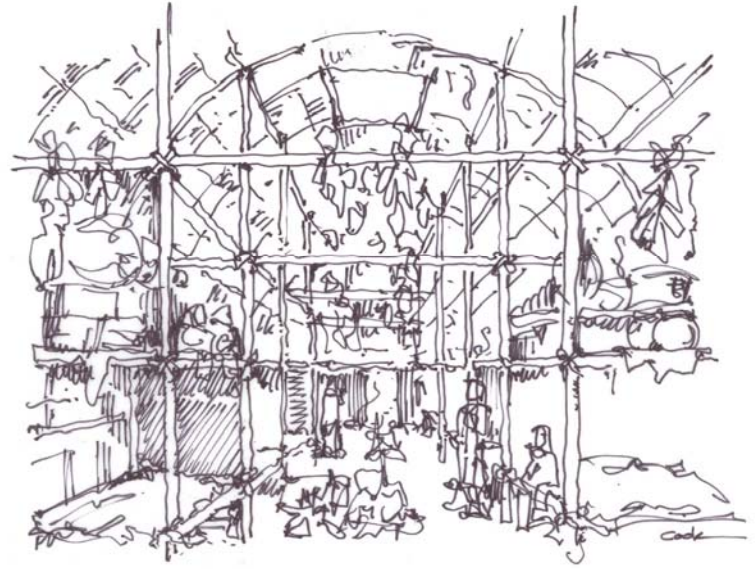

"In every deliberation, we must consider the impact on the seventh generation..."

... even if it requires having skin as thick as the bark of a pine."

-The Constitution of the Iroquois Nations:
"The Great Binding Law," 1142



Sustaining Life

How Human Health Depends on Biodiversity

FOREWORD BY EDWARD O. WILSON

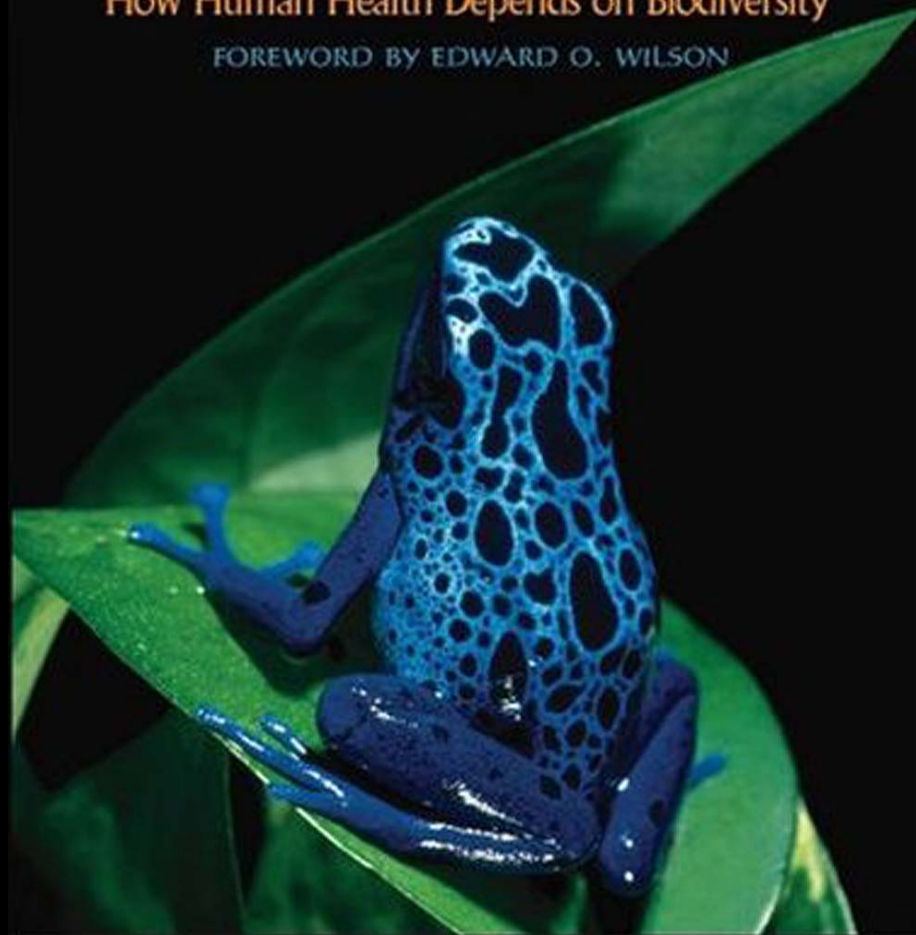

Edited by Eric Chivian and Aaron Bernstein

THE WAYFINDERS

*Why Ancient Wisdom Matters
in the Modern World*

WADE DAVIS



“I believe we need a new definition of success. One not measured by the quantity of stuff, but by the quality of life.”

- E.O. Wilson, Greenbuild, Boston, Nov 2008

"Insanity: doing the same thing over and over again and expecting different results."

- Albert Einstein